

Edison Triumph Phonograph

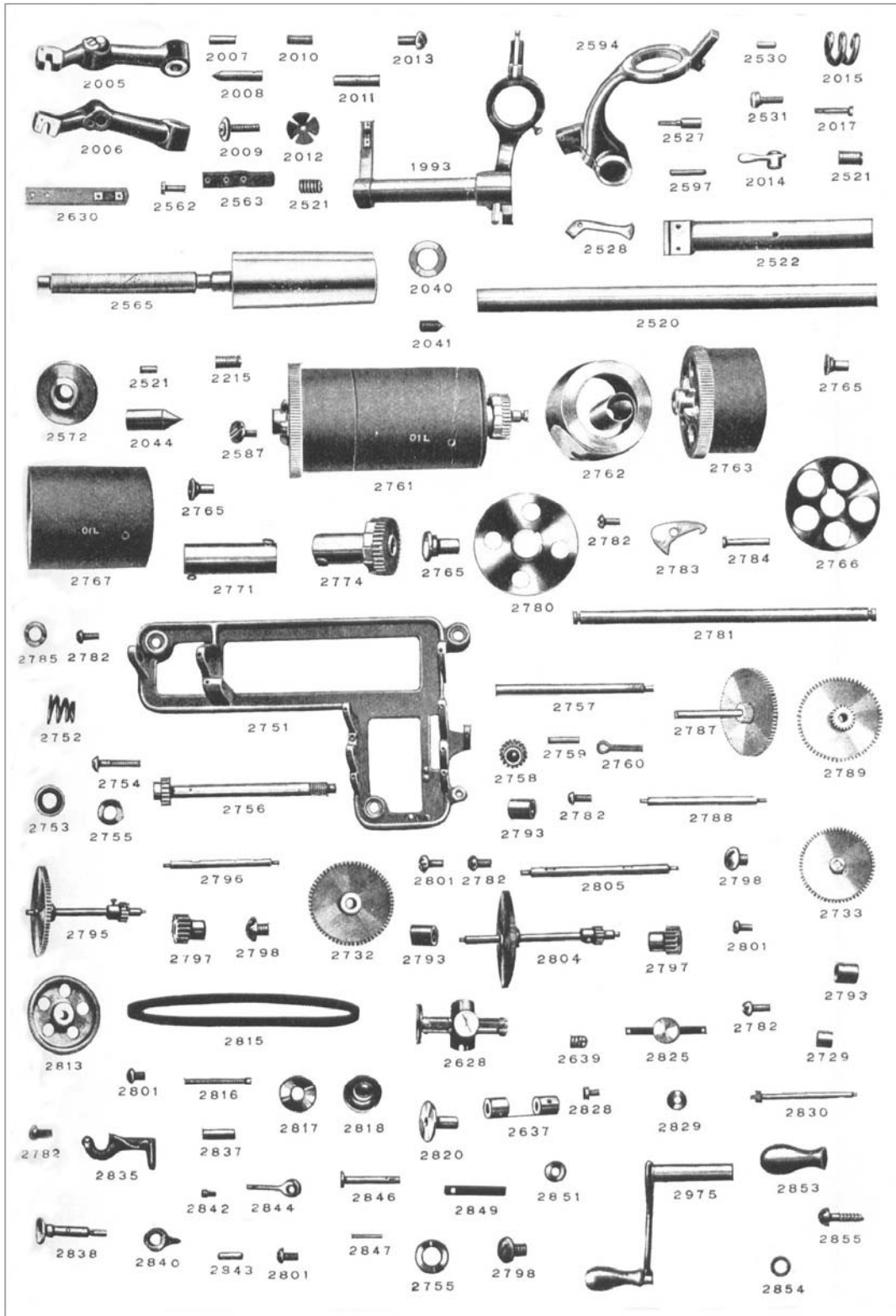

EDISON TRIUMPH

<u>Number</u>	<u>Item</u>	<u>Price</u>
1993	See # 2522 & # 2594	\$ --
2005	End Gate	20.00
2006	See # 2005	--
2007	Carriage Pin	.50
2008	Mandrel End Bearing - right	4.00
2009	End Bearing Adjusting Screw	4.50
2010	End Bearing Set Screw	.50
2011	End Gate Stud	2.50
2012	End Gate Spring Washer	2.00
2013	End Gate Washer Screw	.50
2014	End Gate Locking Lever	15.00
2015	Locking Lever Spring	.75
2017	Locking Lever Stud	1.00
2038	Feed Screw Collar 2 & 4 - Minute Pulley and Gear Unit - Model D	40.00
2039	Mandrel Shaft Center Bearing - Model D	7.00
2040	Feed Screw Collar	8.00
2041	Feed Screw Collar Set Screw	.50
2044	Feed Screw End Bearing - left	3.00
2045	Feed Screw End Bearing and Gear - Model D	18.00
2046	Feed Screw Collar - right - Model D	20.00
2152	Case Handle	18.00
2215	Feed Screw End Bearing Set Screw	.50
2520	Carriage Rod	12.00
2521	Carriage Rod Set Screw	.50
2522	Carriage Sleeve	55.00
2527	Carriage Clamp Screw	4.50
2528	Carriage Lift Lever	14.00
2530	Carriage Locating Pin	.50
2531	Reproducer Locking Screw	4.00
2562	Feed Nut Bar Screw	.50
2563	Feed Nut Bar Guard	12.00
2565	Mandrel and Lead Screw	55.00
2566	Mandrel and Shaft - Model D	55.00
2567	Feed Screw - Model D	50.00
2572	Upper Pulley	10.00
2587	Feed Screw and End Bearing Stop Screw	3.00

<u>Number</u>	<u>Item</u>	<u>Price</u>
2594	Carriage (complete, less sleeve) - 45-Degree Type	\$ 70.00
2595	Carriage (complete, less sleeve) - Top Mount Type	70.00
2597	Carriage Lift Lever Pin	.50
2628	Governor	50.00
2630	Feed Nut and Bar	Inquire
2631	Feed Nut	Inquire
2632	Feed Nut Bar	Inquire
2637	Governor Carrier Collar / wire	n/a
2639	Carrier Set Screw	.50
2729	Governor End Bearing	3.50
2732	#5 Gear	20.00
2733	#6 Gear	20.00
2751	Motor Frame	50.00
2752	Motor Frame Spring	n/a
2753	Motor Frame Spring Washer	.50
2754	Motor Frame Mounting Screw	1.00
2755	Motor Frame Mounting Screw Washer	.25
2756	Winding Shaft and Gear	25.00
2757	See # 2756	--
2758	See # 2756	--
2759	See # 2756	--
2760	Winding Shaft Cotter Pin	N/A
2761	Spring Barrels (complete with springs & gears)	Inquire
2762	Main Spring	n/a
2763	Single Spring Barrel	Inquire
2765	Spring Barrel Pin	N/A
2766	Spring Retainer	7.50
2767	Double Spring Barrel	Inquire
2771	Double Spring Barrel Winding Shaft	20.00
2774	Single Spring Barrel Winding Shaft and Gear	30.00
2780	Spring Barrel Cover	15.00
2781	Spring Barrel Center Shaft	8.00
2782	Set Screw	.50
2783	Winding Ratchet Pawl	7.00
2784	Winding Ratchet Pawl Stud	1.00
2785	Winding Ratchet Pawl Stud Washer	.25
2787	First Shaft with #1 & #2 Gear	40.00
2788	First Shaft	10.00

Number	Item	Price
2789	#1 & #2 Gear Without Shaft	\$ 35.00
2793	Shaft Bearing	2.50
2795	Second Shaft with #3 & #4 Gear	40.00
2796	Second Shaft	8.00
2797	#3 Gear without Shaft	20.00
2798	Set Screw	.50
2804	Third Shaft with #5 & #6 Gear	35.00
2805	Third Shaft	8.00
2813	Lower Belt Pulley	25.00
2815	Belt	Inquire
2816	Belt Tension Screw	4.50
2817	Belt Tension Screw Washer	.25
2818	Belt Tension Screw Nut	5.00
2820	Governor Disc and Sleeve	15.00
2825	Governor Spring and Weight	5.00
2828	Governor Spring Screw and Washer (set of 6)	2.00
2830	Governor Shaft and Gear	30.00
2835	Speed Control Yoke	22.50
2837	See # 2835	--
2838	Speed Adjusting Screw	15.00
2840	Speed Indicator	15.00
2842	Speed Indicator Set Screw	.50
2843	Speed Indicator Stop Pin	N/A
2844	Starting Lever	15.00
2846	Starting Lever Stud	4.00
2849	Starting Lever Spring	2.50
2853	Crank Knob	6.00
2877	Case Bumper (rubber foot)	.40
2975	Winding Crank (threaded)	65.00
2976	Bedplate - Model B	40.00
2977	Bedplate - Model D	50.00
3180	Oak Case - Model A	Inquire
3181	Oak Case - Model B	Inquire
3182	Oak Case- Model D	Inquire
3183	Oak Cover - Model A	Inquire
3184	Oak Cover- Model B	Inquire
3185	Oak Cover – Model D	Inquire
3189	Oak Bedplate Frame - Model A	Inquire
3190	Oak Bedplate Frame - Model B & D	Inquire